

Memorandum

To: Honorable Mayor Shetter and members of the Burleson City Council

From: Aaron Russell, P.E., Director Public Works

Date: August 3, 2009

Subject: Award the bid for the construction of the 2008 Quil Miller Creek Wastewater Trunk Main Construction Project (Phase 2) and authorize the City Manger to approve change orders not exceeding \$25,000.00.

Council Action Requested:

Award the bid for the construction of the 2008 Quil Miller Creek Wastewater Trunk Main Construction Project (Phase 2) to W. R. Hodgson Co., LP in the amount of \$1,716,294.70 and authorize the City Manager to execute change orders not exceeding \$25,000.00.

Background Information:

The 2008 Quil Miller Creek Wastewater Trunk Main Construction Project (Phase 2) project was originally identified in the 2005-2009 Capital Improvements Program. This is the second phase of the construction of the Quil Miller Wastewater Trunk Main, which extends from near Southern Oaks Golf Course, south to the vicinity of CR 711. The sewer will serve the Burleson Business Park initially, and will be available for future development in the Quil Miller Creek drainage basin. Phase 2 extends in a southerly direction from near Hidden Creek Parkway to the east side of I-35W. This phase will complete the Quil Miller Wastewater Trunk Main Construction Project providing sanitary sewer service to the Business Park. Time for completion of the project is 150 calendar days.

On July 14, 2009, the City of Burleson opened bids for the construction of the 2008 Quil Miller Creek Wastewater Trunk Main Construction Project (Phase 2). The City received twenty-one (21) responsive bids for the project. The lowest bid was from W. R. Hodgson Co., LP of Celina, Texas, in the amount of \$1,716,294.70. W.R. Hodgson successfully constructed Quil Miller Creek Wastewater Trunk Main Construction Project (Phase 1).

Staff recommends award of the second phase of the Quil Miller Creek Wastewater Trunk Main Construction Project to W.R. Hodgson Co., LP.

Board/Citizen Input:

N/A

Financial Considerations:

4A Funds, PW Department (Account # 332-7248-439.79-98)

Attachments:

1. Project location map.
2. Bid Tabulation showing 3 low bidders.

Staff Contact:

Lance J. Barton, P.E., Civil Engineer
817-447-5400 ext. 278
lbarton@BurlesonTx.com

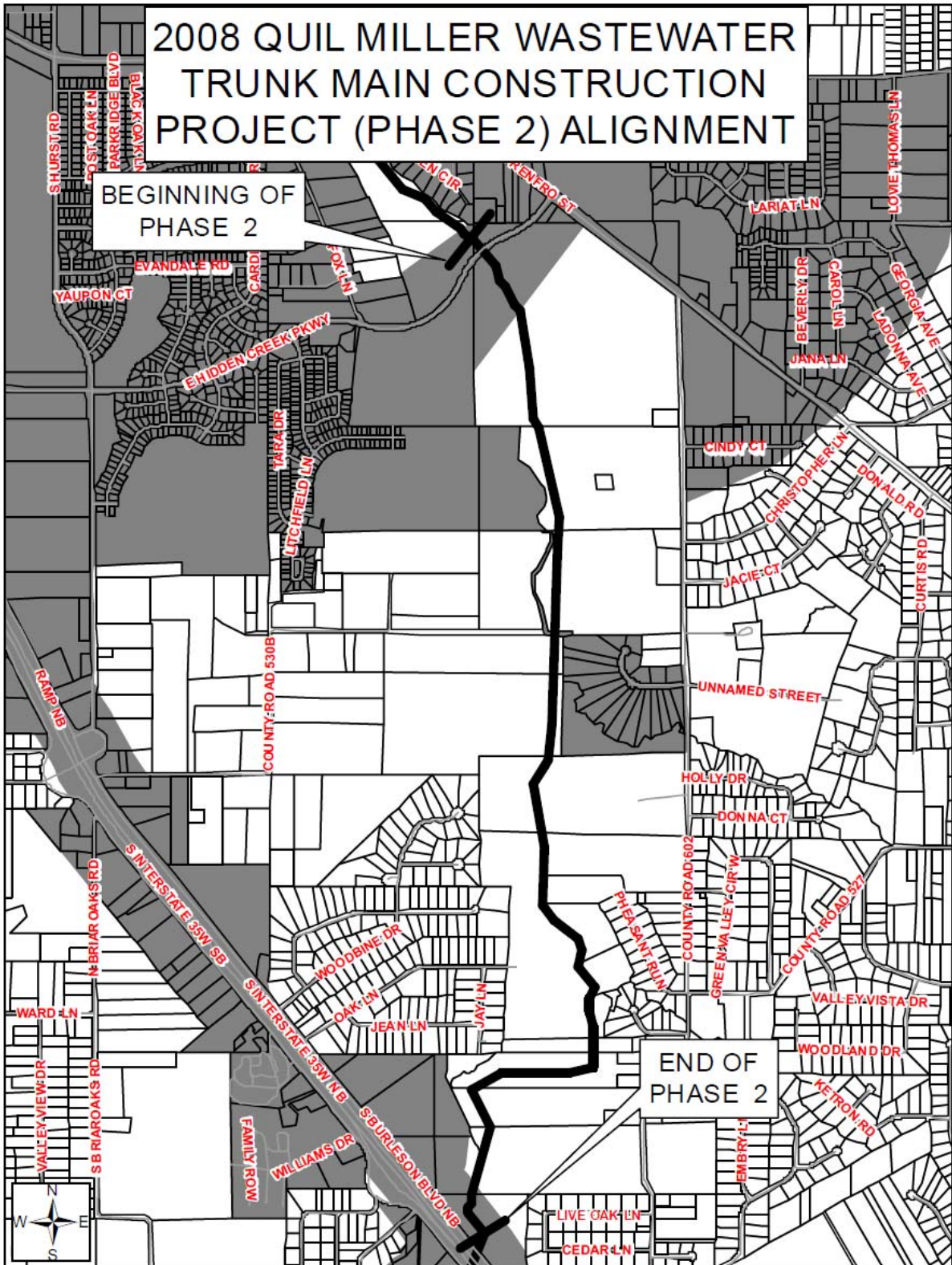

BID TABULATION
2009 QUIL MILLER CREEK WASTEWATER TRUNK MAIN (PHASE 2) CONSTRUCTION PROJECT - BURLESON, TX

ITEM	ITEM DESCRIPTION	QTY	UNIT	W.R. Hodgson		Circle C Construction		Utilitex Construction		
				UNIT PRICE	TOTAL	UNIT PRICE	TOTAL	UNIT PRICE	TOTAL	
UNIT 1										
101	MOBILIZATION, BONDS, INSURANCE	1	LS	\$46,000.00	\$46,000.00	\$60,000.00	\$60,000.00	\$10,000.00	\$10,000.00	
102	TRAFFIC CONTROL	1	LS	\$4,000.00	\$4,000.00	\$2,000.00	\$2,000.00	\$2,500.00	\$2,500.00	
103	PROJECT SIGNS	3	EA	\$350.00	\$1,050.00	\$500.00	\$1,500.00	\$825.00	\$2,475.00	
104	IMPLEMENT BEST MGMT PRACTICES	1	LS	\$80,000.00	\$80,000.00	\$15,000.00	\$15,000.00	\$2,500.00	\$2,500.00	
105	EPA INFO. SIGN	1	EA	\$1.00	\$1.00	\$1,000.00	\$1,000.00	\$1,350.00	\$1,350.00	
106	SWPPP	1	LS	\$1,000.00	\$1,000.00	\$1,000.00	\$1,000.00	\$52,500.00	\$52,500.00	
107	CLEARING & GRUBBING	20	AC	\$1,500.00	\$30,000.00	\$1,000.00	\$20,000.00	\$1,825.00	\$35,500.00	
108	TEMP. CLAY DAMS & DEWATERING	34	EA	\$200.00	\$6,800.00	\$1,000.00	\$34,000.00	\$230.00	\$7,620.00	
109	REMOVE & REPLACE FENCES	3,432	LF	\$4.80	\$16,473.60	\$5.00	\$17,160.00	\$3.50	\$12,012.00	
110	FURN. & INSTALL 12" PERM. ACCESS GATE	13	EA	\$200.00	\$2,600.00	\$800.00	\$7,800.00	\$185.00	\$2,405.00	
111	FURN. & INSTALL 18" PERM. ACCESS GATE	1	EA	\$200.00	\$200.00	\$800.00	\$800.00	\$210.00	\$210.00	
112	FURNISH & INSTALL TEMP. FENCING	7,429	LF	\$4.80	\$35,659.20	\$5.00	\$37,145.00	\$3.50	\$26,001.50	
113	REPAIR EXIST. GRAVEL ROAD/PAD W/FLEX BASE	3,973	SY	\$15.30	\$60,796.90	\$15.00	\$59,595.00	\$9.75	\$38,736.75	
114	REPAIR EXIST. ROAD/PAD W/REINFORCED CONC.	13	SY	\$100.00	\$1,300.00	\$95.00	\$1,235.00	\$61.00	\$793.00	
115	DESIGN/IMPLEMENT TRENCH SAFETY PLAN	13,684	LF	\$1.00	\$13,684.00	\$0.50	\$6,842.00	\$1.00	\$13,684.00	
116	FURN & INSTALL 24" CMP STORM DRAIN PIPE	36	LF	\$40.00	\$1,440.00	\$60.00	\$2,160.00	\$50.00	\$1,800.00	
117	FURN & INSTALL 21" CMP STORM DRAIN PIPE	20	LF	\$37.00	\$740.00	\$65.00	\$1,300.00	\$44.00	\$880.00	
118	REPAIR EXISTING IRRIGATION LINE	885	LF	\$11.00	\$9,735.00	\$5.00	\$4,425.00	\$5.00	\$4,425.00	
119	12" - 18" ROCK RIP RAP	103	SY	\$50.00	\$5,150.00	\$95.00	\$9,785.00	\$35.00	\$3,605.00	
120	MODIFY LOW WATER CROSSING	1	LS	\$10,000.00	\$10,000.00	\$10,000.00	\$10,000.00	\$10,000.00	\$10,000.00	
121	CLEAR UNDERBRUSH AT ENGINEER'S DIRECTION	1	AC	\$1.00	\$1.00	\$1,000.00	\$1,000.00	\$1,950.00	\$1,950.00	
					UNIT 1 TOTAL	\$328,620.70	\$293,747.00	\$232,147.25		
UNIT 2										
201	FURN & INSTALL 6' DIAM. STD MANHOLE W/LID	2	EA	\$6,000.00	\$12,000.00	\$3,500.00	\$7,000.00	\$5,425.00	\$10,850.00	
202	EXTRA DEPTH FOR 6' DIAMETER MANHOLES	9	VF	\$300.00	\$2,700.00	\$150.00	\$1,350.00	\$425.00	\$3,825.00	
203	FURN. & INSTALL 5' DIAMETER STD MANHOLE	1	EA	\$4,400.00	\$4,400.00	\$2,800.00	\$2,800.00	\$4,195.00	\$4,195.00	
204	FURN & INSTALL 5' DIAM. STD MANHOLE W/LID	26	EA	\$4,000.00	\$104,000.00	\$3,000.00	\$78,000.00	\$4,450.00	\$115,700.00	
205	FURN & INSTALL 5' DIAM STD MANHOLE W/LID & VENT	13	EA	\$5,500.00	\$71,500.00	\$3,600.00	\$48,400.00	\$4,750.00	\$61,750.00	

2009 QUIL MILLER CREEK WASTEWATER TRUNK MAIN (PHASE 2) CONSTRUCTION PROJECT - BURLESON, TX
BID TABULATION

ITEM	ITEM DESCRIPTION	QTY	UNIT	W.R. Hodgson		Circle C Construction		Utilitex Construction	
				UNIT PRICE	TOTAL	UNIT PRICE	TOTAL	UNIT PRICE	TOTAL
206	EXTRA DEPTH FOR 5' DIAMETER MANHOLES	379.5	VF	\$280.00	\$106,260.00	\$125.00	\$47,437.50	\$328.00	\$124,476.00
207	FURN. & INSTALL 36" CORRUG/RIBBED PVC SS PIPE	399	LF	\$67.00	\$26,733.00	\$63.00	\$25,137.00	\$59.00	\$23,541.00
208	INSTALL 36" PVC PIPE BY OTHER THAN OPEN CUT W/45" STEEL CASING PIPE	181	LF	\$460.00	\$83,260.00	\$450.00	\$81,450.00	\$490.00	\$88,690.00
209	REMOVE 36" PLUG & CONNECT TO EXIST. 36" PVC	1	EA	\$2,200.00	\$2,200.00	\$1,500.00	\$1,500.00	\$1,650.00	\$1,650.00
210	CONCRETE ENCASEMENT	190	CY	\$100.00	\$19,000.00	\$125.00	\$23,750.00	\$113.00	\$21,470.00
211	FURN & INSTALL 21" CORRUG/RIBBED PVC SS PIPE	14,950	LF	\$33.60	\$502,320.00	\$40.00	\$598,000.00	\$40.00	\$598,000.00
212	INSTALL 21" PVC PIPE W/CONCRETE ENCASE.	69	LF	\$43.00	\$2,967.00	\$65.00	\$4,485.00	\$37.00	\$2,553.00
213	INSTALL 21" PVC PIPE BY OTHER THAN OPEN CUT W/30" STEEL CASING PIPE	1,562	LF	\$287.00	\$448,294.00	\$350.00	\$546,700.00	\$300.00	\$468,600.00
214	PLUG 21" PVC SANITARY SEWER	1	EA	\$300.00	\$300.00	\$500.00	\$500.00	\$625.00	\$625.00
215	PLUG 8" PVC SANITARY SEWER	1	EA	\$240.00	\$240.00	\$200.00	\$200.00	\$300.00	\$300.00
216	FURNISH & INSTALL WATER GAP CROSSING	1	EA	\$1,500.00	\$1,500.00	\$5,000.00	\$5,000.00	\$10,000.00	\$10,000.00
UNIT 2 TOTAL					\$1,387,674.00		\$1,472,709.50		\$1,536,225.00
GRAND TOTAL					\$1,716,294.70		\$1,766,456.50		\$1,768,372.25